

V5A51 LOWER VALVE BODY EXPLODED VIEW

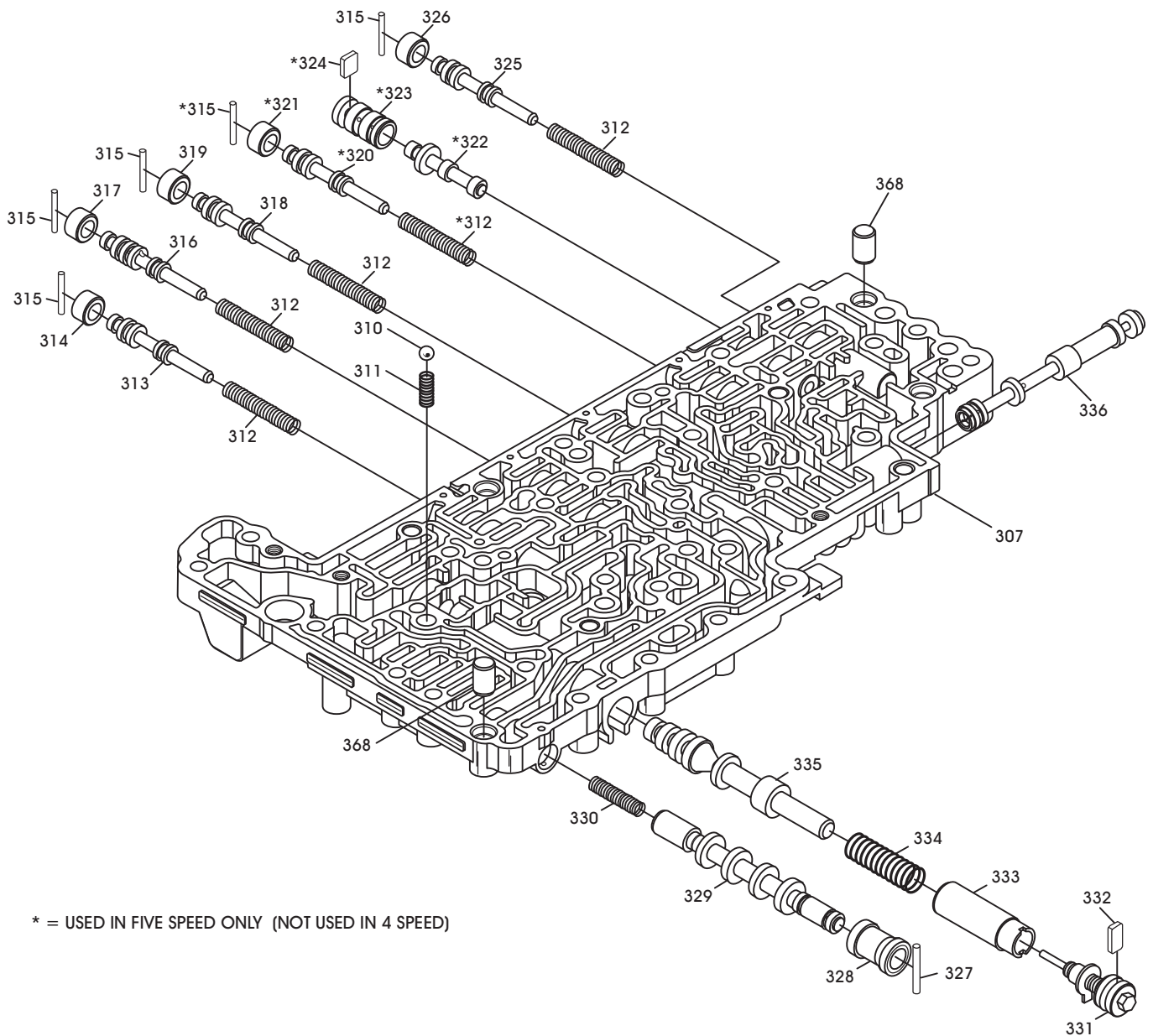

* = USED IN FIVE SPEED ONLY (NOT USED IN 4 SPEED)

- | | |
|--|---|
| 307 LOWER VALVE BODY ASSEMBLY | 324 FAIL-SAFE VALVE "C" SLEEVE RETAINER |
| 310 LINE PRESSURE RELIEF BALL, (.250" STEEL) | 325 LOW REVERSE BRAKE PRESSURE CONTROL VALVE |
| 311 LINE PRESSURE RELIEF BALL SPRING, (SEE SPRING SPEC'S) | 326 LOW REVERSE BRAKE PRESSURE CONTROL VALVE SLEEVE |
| 312 VALVE RETURN SPRINGS, 5 REQUIRED (SEE SPRING SPECS) | 327 TCC CONTROL VALVE RETAINING PIN, (.117 DIA. 1.012 LONG) |
| 313 OVERDRIVE CLUTCH PRESSURE CONTROL VALVE | 328 TCC CONTROL VALVE SLEEVE |
| 314 OVERDRIVE CLUTCH PRESSURE CONTROL VALVE SLEEVE | 329 TCC CONTROL VALVE |
| 315 VALVE RETAINING PIN, .097" DIA .854" LONG (5 REQUIRED) | 330 TCC CONTROL VALVE SPRING |
| 316 UNDERDRIVE CLUTCH PRESSURE CONTROL VALVE | 331 PRESSURE REGULATOR VALVE ADJUSTING SCREW |
| 317 UNDERDRIVE CLUTCH PRESSURE CONTROL VALVE SLEEVE | 332 PRESSURE REGULATOR VALVE RETAINER |
| 318 2ND BRAKE CLUTCH PRESSURE CONTROL VALVE | 333 PRESSURE REGULATOR VALVE SLEEVE |
| 319 2ND BRAKE CLUTCH PRESSURE CONTROL VALVE SLEEVE | 334 PRESSURE REGULATOR VALVE SPRING |
| 320 REDUCTION BRAKE BAND PRESSURE CONTROL VALVE | 335 PRESSURE REGULATOR VALVE |
| 321 REDUCTION BRAKE BAND PRESSURE CONTROL VALVE SLEEVE | 336 MANUAL VALVE |
| 322 FAIL-SAFE VALVE "C" | 368 LONG, HOLLOW LOCATING DOWEL, (.509" IN LENGTH) |
| 323 FAIL-SAFE VALVE "C" SLEEVE | |

Copyright © 2008 ATSG

Figure 163